

NOTES:

1. PRIME MASONRY SURFACES AND ALLOW TO DRY BEFORE INSTALLING THE FLASHING SYSTEM
2. A METAL COUNTER FLASHING CAN BE SUBSTITUTED FOR THE 2 PLY WALL FLASHING LOCATED ABOVE THE LOWER BASE FLASHING.

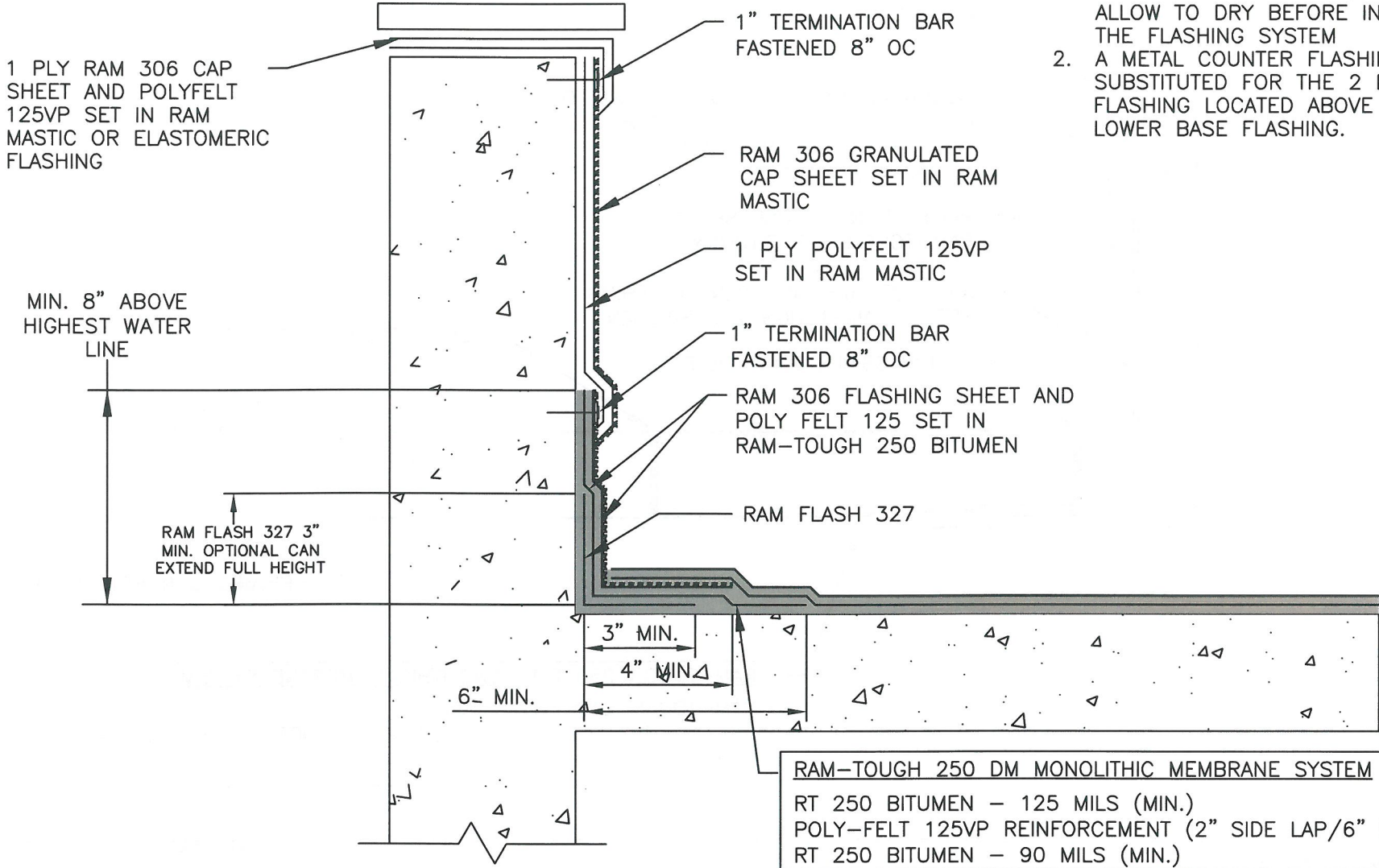

RAM-TOUGH 250 DM MONOLITHIC MEMBRANE SYSTEM
 RT 250 BITUMEN – 125 MILS (MIN.)
 POLY-FELT 125VP REINFORCEMENT (2" SIDE LAP/6" END LAP)
 RT 250 BITUMEN – 90 MILS (MIN.)



Between the World
 and The Weather
 Since 1928
 1.800.647.0100

www.barrettroofs.com

**RAM-TOUGH 250 DM
 WATERPROOFING SYSTEMS**

**HIGH WALL FLASHING
 DETAIL WITH STONE CAP**
 (DRAWING NOT TO SCALE)

DRAWING NUMBER:
RT250-07
 DATE ISSUED:
04/2016