

CLAMP TOP OF FLASHING SHEET WITH A STAINLESS STEEL CLAMPING RING AND SEALANT

WRAP PIPE WITH RAM 327 HDR NEOPRENE FLASHING SET IN RT 250 AND TOP COATED WITH RT 250

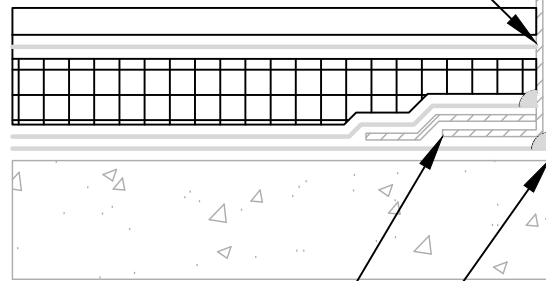

STAR CUT NEOPRENE FLASHING TO FLARE OUT ONTO DECK 3" MIN.

BUILD UP RAM-TOUGH 250 IN ALL CORNERS

PIPE VENT

IF FLASHING IS EXPOSED, INSTALL RAM 306 GRANULATED FLASHING, SET IN RT 250 OVER THE NEOPRENE, BEFORE CLAMP IS INSTALLED OR COAT WITH RAM ULTRA-WHITE COATING SYSTEM

3" MIN

7" MIN

APPROVED SURFACING (STONE, PAVERS, ETC.)

POLY-FELT 3.5 FILTER FABRIC

XPS INSULATION

PROTECTION COURSE SET IN RAM-TOUGH 250

PRIMED CONCRETE DECK

RAM-TOUGH 250 DM MONOLITHIC MEMBRANE SYSTEM
 RAM-TOUGH 250 (125 MILS)
 POLY-FELT 125VP REINFORCEMENT (2" SIDE LAP/6" END LAP)
 RAM-TOUGH 250 (90 MILS)

COVER THE NEOPRENE STAR CUT FLANGE WITH AN ADDITIONAL SHEET OF 327 HDR NEOPRENE, (24" SQUARE), CENTERED OVER THE PIPE, IN THE CENTER OF THE SHEET CUT A HOLE, SLIGHTLY SMALLER THAN THE WIDTH OF THE PIPE, SO IT SLIPS TIGHTLY OVER THE PIPE. SET SHEET IN RT 250 AND PRESS FIRMLY INTO PLACE.



Between the World
and The Weather
Since 1928

1.800.647.0100

www.barrettroofs.com

**RAM-TOUGH 250DM
WATERPROOFING AND
ROOFING SYSTEMS**

**FIELD WRAPPED
VENT PIPE FLASHING**
(DRAWING NOT TO SCALE)

DRAWING NUMBER:

RT250-10

DATE ISSUED:

4/2016